

Rhino to 3ds Max

1. open your rhino model
2. Select portion of model you would like to export

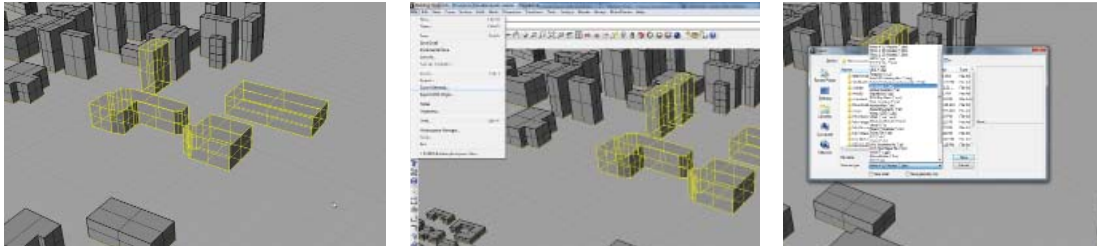

3. From the menu tab, select 'file' and scroll down to export
4. In the 'save as type' field, select '.3ds' file extension
5. Open up a new or existing 3ds max scene

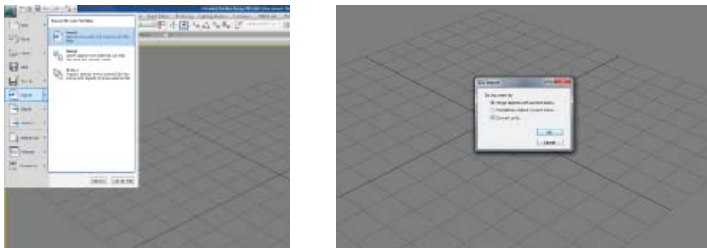

6. Click the home tab and select 'import non-native formats into 3ds max'
7. Scroll through to find your .3ds extension file that you exported from rhino
8. In the prompt window select 'merge with current scene' if you are adding to an existing scene, or select 'completely replace current scene' to start from scratch with your new model.